

Installation Instructions

1. Mounting

Mounting considerations

- Select a place where temperature and humidity are stable and moderate.
- Select a place where dust is minimal.
- Leave sufficient space around the sides and rear of the unit for maintenance and checking.
- This unit cannot be fixed to a bulkhead.
- Mount this unit in parallel with "fore-aft" line (ship's keel line) to minimize vibration of paper by ship's rolling.

Mounting

Attach the double-sided tapes (supplied) to the rear side of the facsimile, referring to the Outline Drawing on page D-1. Mount the unit on a tabletop, where it can be easily operated.

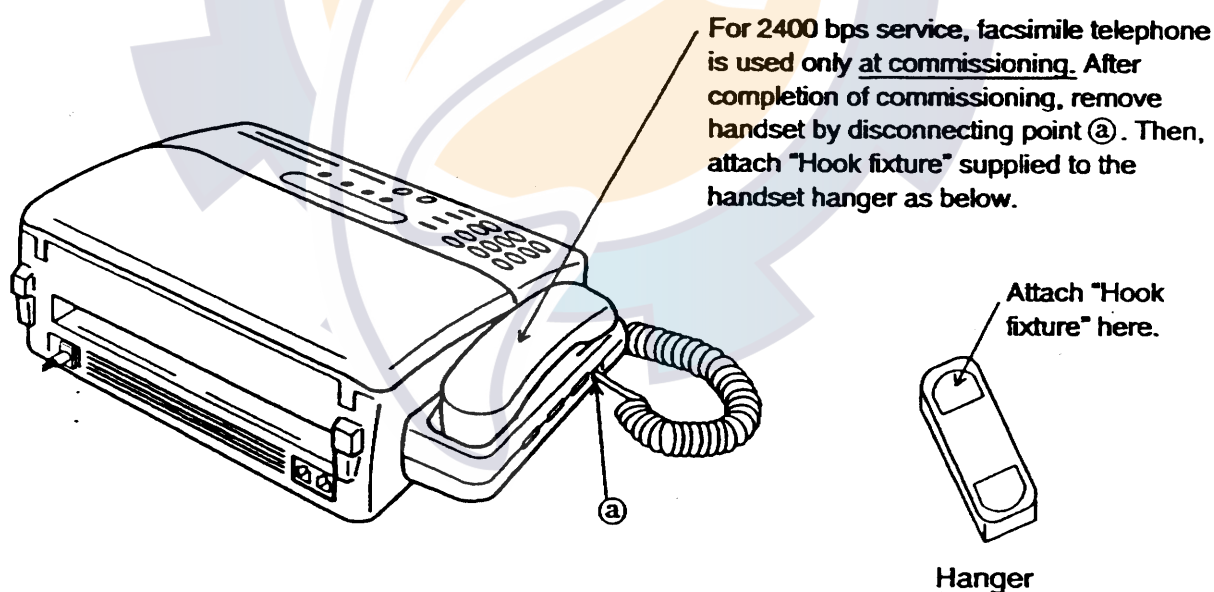

2. Connection

Connect a modular plug to the "LINE" jack on the rear side of the PFX-50. See the figure below. Another modular plug should be connected to either the IB-311 via a modular jack box or the IB-280 directly, depending on number of facsimile. For further details, refer to the Installation Manual of the FELCOM 80.

3. Changing dialing format

Change dialing format from "pulse (dial)" to "pushbutton".

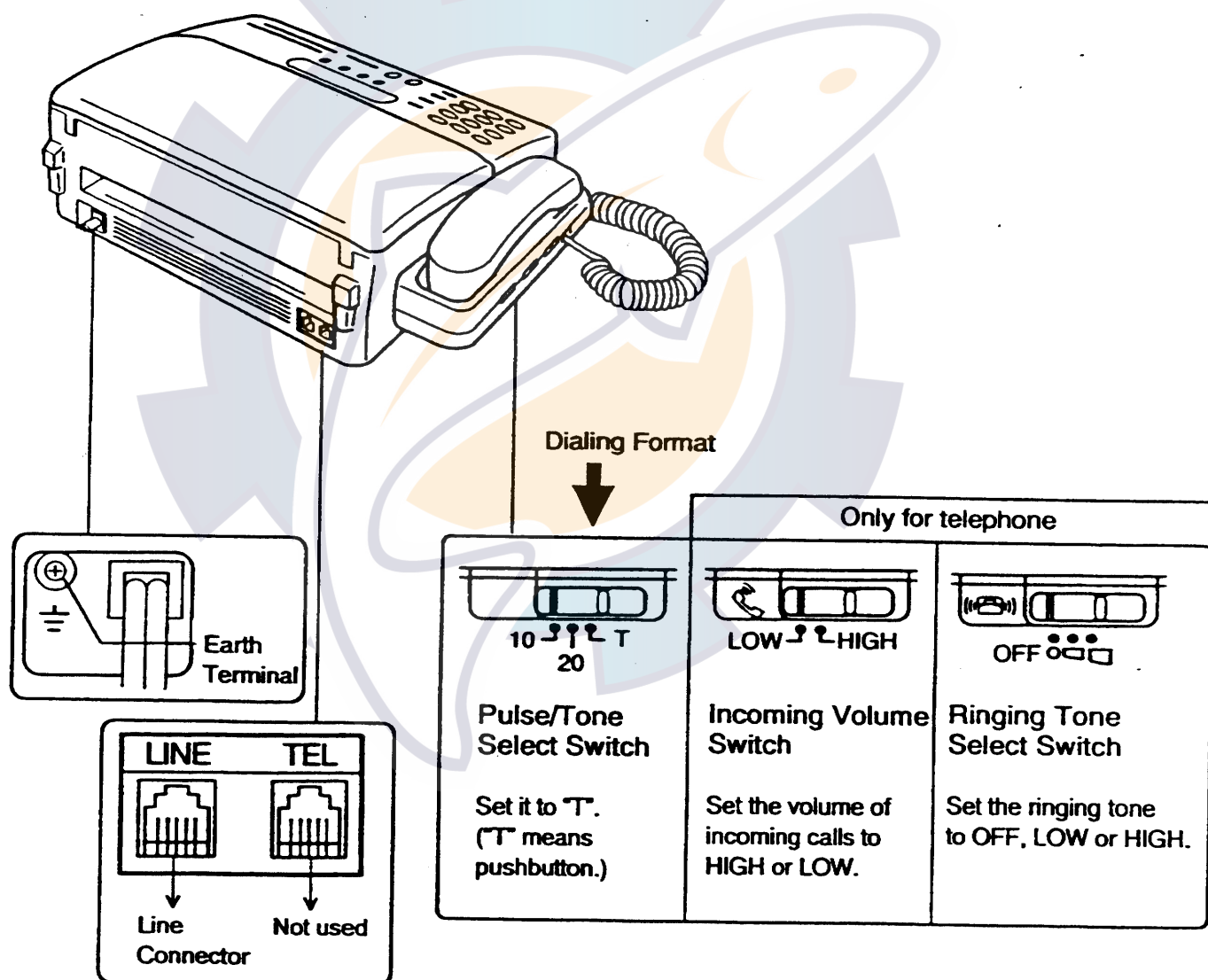

After connection is completed, attach the English language seal (supplied) to the front panel of the facsimile. Further, both the compass safe distance seal and Inmarsat "B" seal (supplied) should be attached to the facsimile.

4. Clearing contents of RAM

To clear all contents of RAM, turn the power on while pressing and holding down the [1], [3] and [*] keys together.

5. Initial setting

After clearing contents of RAM, display should look something like the figure shown below. Set and enter the followings:

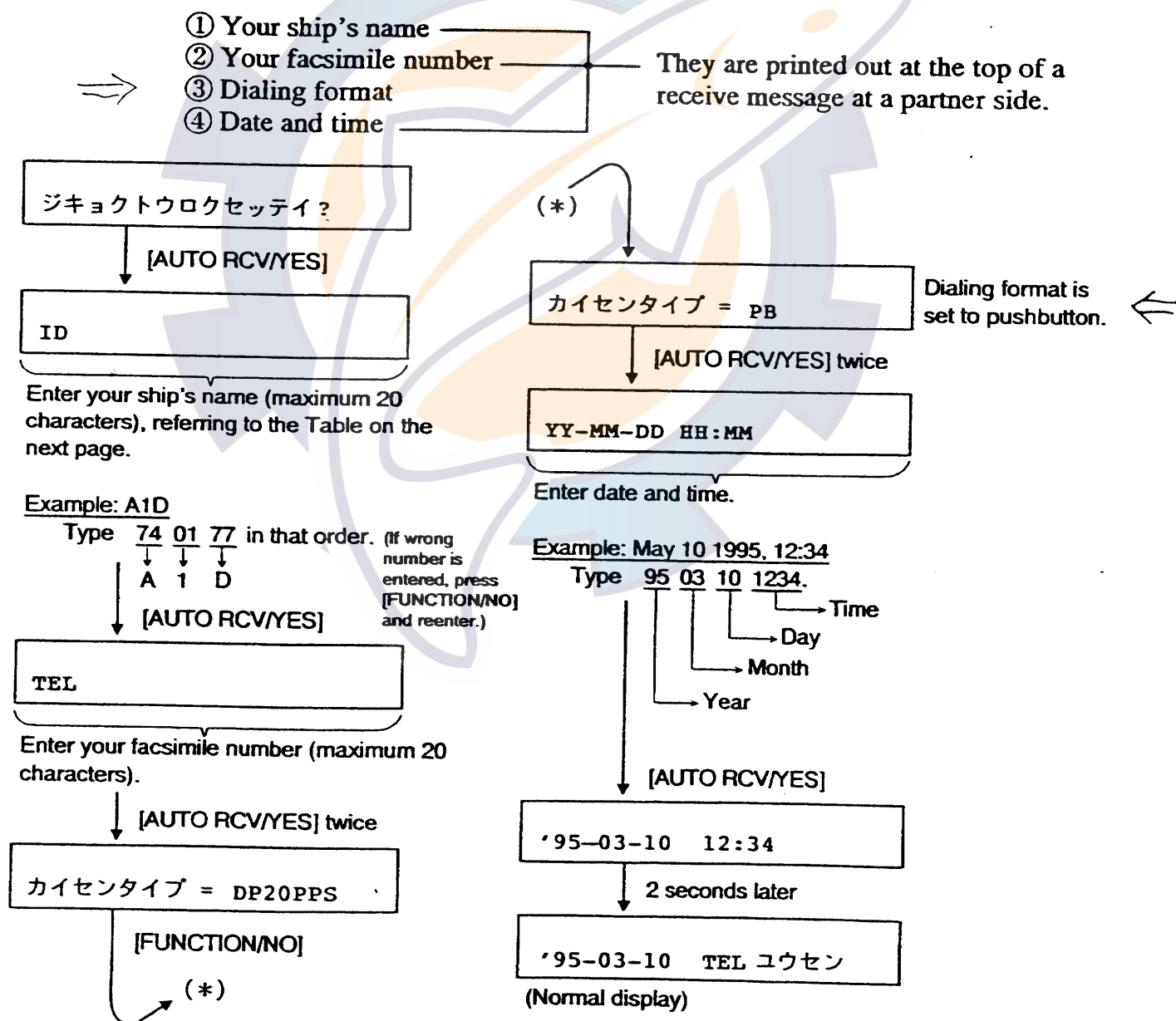
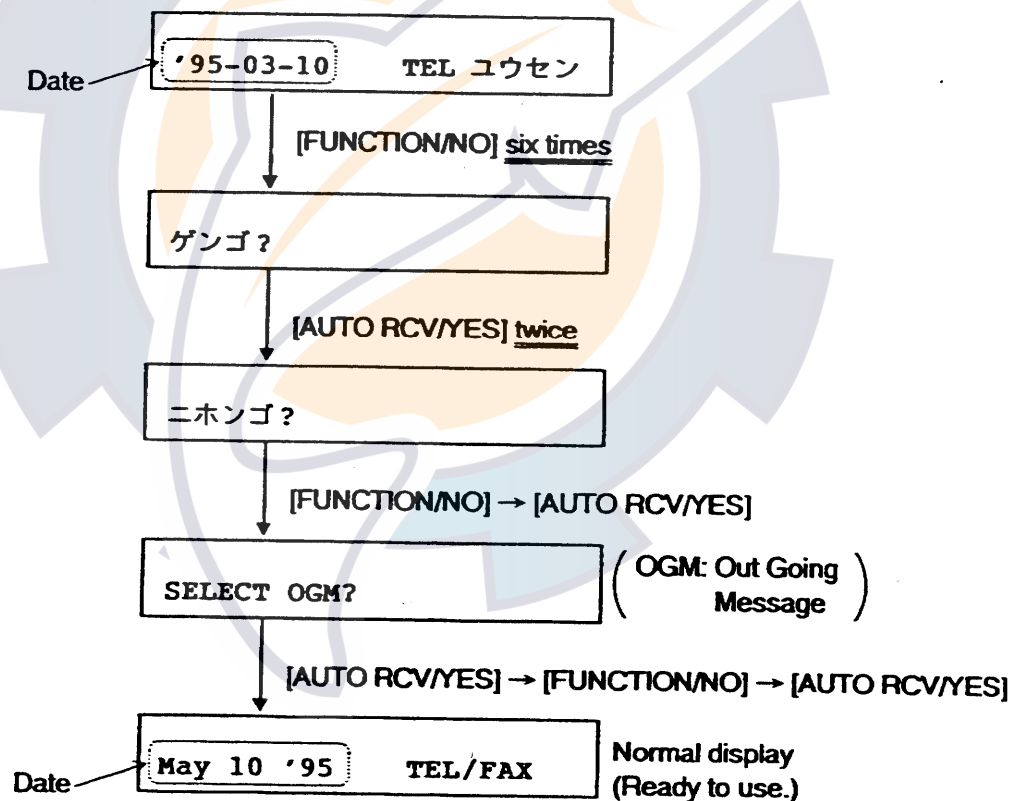

TABLE OF THE CHARACTER CODE FOR ENGLISH LETTER

LETTER	0	1	2	3	4	5	6	7	8	9
CODE	00	01	02	03	04	05	06	07	08	09
LETTER	SPACE	.	.	-	.	/	:	()	
CODE	65	66	67	68	69	70	71	72	73	
LETTER	A	B	C	D	E	F	G	H	I	J
CODE	74	75	76	77	78	79	80	81	82	83
LETTER	K	L	M	N	O	P	Q	R	S	T
CODE	84	85	86	87	88	89	90	91	92	93
LETTER	U	V	W	X	Y	Z				
CODE	94	95	96	97	98	99				

6. Changing language from Japanese to English



Then, set the receive mode to the "FAX" referring to page 3-1.

7. Loading a recording paper

See page 2-1.

8. Setting Modem Speed, Turning Line Monitor On/Off

Default settings

Modem speed: 9600 bps

Line monitor: Off

1. Turn the power on while pressing [1] and [3] keys to get into the test mode. Release the keys when the date appears. (Now you are in test mode.)

2. Press [FUNCTION/NO], [8], [FUNCTION/NO] (three times) and [AUTO RCV/YES] in that order.

FUNCTION 0 = 00010010

3. Press 0, 0, 0, 1, 0, 0, 0, 0 in that order to change modem speed from 9600 bps to 2400 bps, 10: 9600 bps, 00: 2400 bps.
(If wrong number is entered, press [FUNCTION/NO] to clear.)

4. Press [AUTO RCV/YES] several times to display the following.

FUNCTION 18 = 00000110

ECM 1: ON
0: OFF

ECM = ERROR CORRECTION MODE

5. Press 0, 0, 0, 0, 0, 1, 1, 1 in that order.

(Line Monitor Setting: ON)

6. Press [AUTO RCV/YES] and [RESET]. The parameter setting is completed.

7. To print out function list and parameter setting, press [FUNCTION/NO], [1], [AUTO RCV/YES], [FUNCTION/NO] twice and [AUTO RCV/YES]. The printing is started.

8. To return to the normal display, turn the power off once and turn it on again.

Set a document face down. Then dial numbers as below.

(ex.) Automatic call to subscriber in Japan via Pacific Ocean LES (Perth)

If you misdial, press the [FUNCTION/NO] button and dial again. (To cancel all input data, press the [RESET] button.)

The redialing feature automatically redials number last dialed. Press the [REDIAL] button.

The abbreviated dialing feature lets you dial a subscriber's number in just two digits. You may register 50 abbreviated dialing numbers, numbered 01 to 50.

Reference: Press a key sequentially within one minute, otherwise display is returned to normal display. Note that you may write over unnecessary facsimile number.

- TEL NUMBER ENTRY?

- ABB. NUMBER = (01-50)

3. Enter abbreviated dialing number followed by the [AUTO RCV/YES] button.

TEL =

4. Enter facsimile number (maximum 38 figures) and [#] followed by the [AUTO RCV/YES] button.

ID =

5. Enter subscriber's name (maximum 20 figures) referring to page 4 at the end of this manual. Then press the [AUTO RCV/YES] button.

(ex) Name: A B C ⇔ Type 74 75 76 in that order.

↓ ↓ ↓
74 75 76

If no input is required, simply press the [AUTO RCV/YES] button.

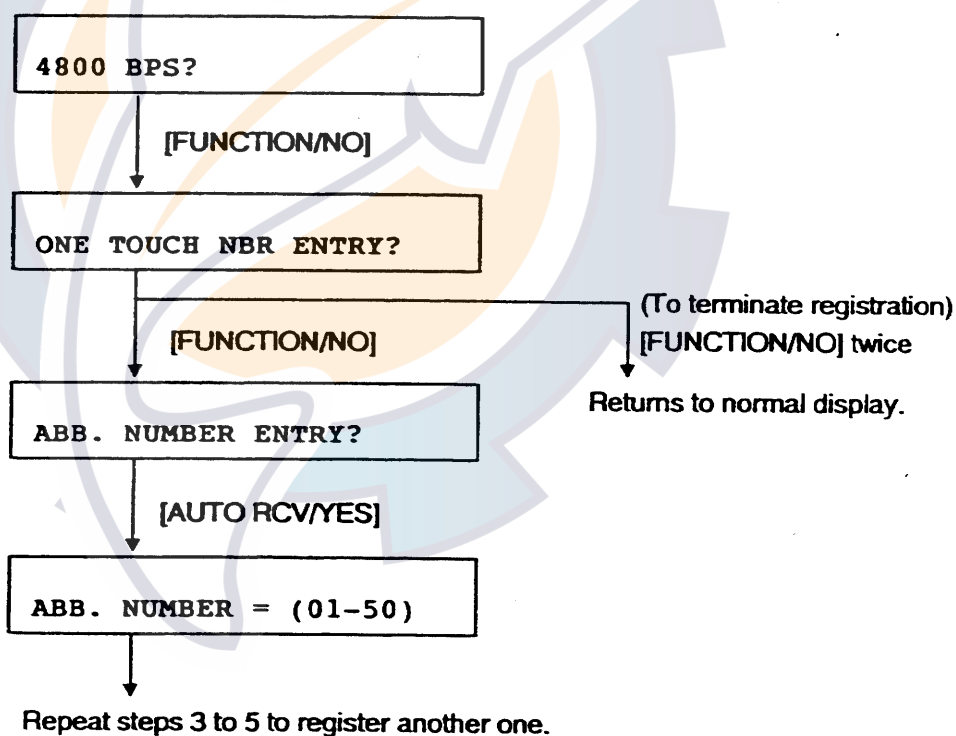

Deleting abbreviated dialing number

1. Do steps 1 to 3 shown above. Then press the [FUNCTION/NO] and [AUTO RCV/YES] buttons in this order.

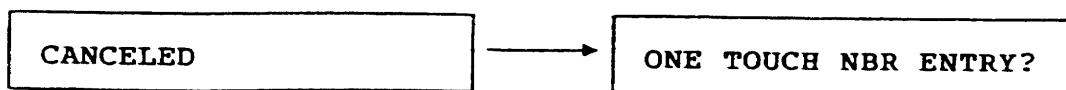

2. Press the [FUNCTION/NO] button twice to return to normal display.

Abbreviated dialing

1. Set a document face down.
2. Press the [ABB. DIAL] button.
3. Key in abbreviated dialing number followed by the [START] button.

4.6 One-touch Dialing (maximum 12 subscribers)

Registering numbers

1. Press the [FUNCTION/NO] button twice.

TEL NUMBER ENTRY?

2. Press the [AUTO RCV/YES] button twice.

ENTER ONE TOUCH KEY

3. Press a one-touch button numbered 01 to 12.

TEL =

4. Enter facsimile number (maximum 38 figures) and [#] followed by the [AUTO RCV/YES] button.

ID =

5. Enter subscriber's name (maximum 20 figures) referring to page 4. Then press the [AUTO RCV/YES] button. If no input is required, simply press the [AUTO RCV/YES] button.

4800 BPS?

[FUNCTION/NO]

ONE TOUCH NBR ENTRY?

[AUTO RCV/YES]

ENTER ONE TOUCH KEY

(To terminate registration)

[FUNCTION/NO] twice

Returns to normal display.

Repeat steps 3 to 5 to register another one.

Deleting one-touch dialing number

1. Do steps 1 to 3 shown above. Then press the [FUNCTION/NO] and [AUTO RCV/YES] buttons in this order.



2. Press the [FUNCTION/NO] button twice to return to normal display.

One-touch dialing

1. Set a document face down.
2. Press a one-touch dialing number (01 – 12).

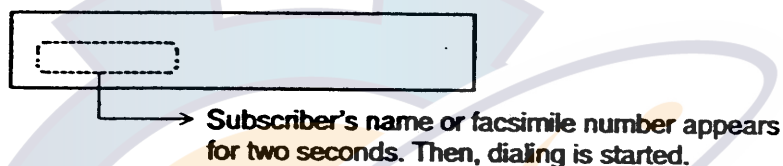

4.7 Multistation Transmission and Memory Transmission

When it is required to send a document to various subscribers, use the multistation transmission. At first set a document face down.

Procedure (for both transmissions)

1. Press the [MEMORY] button.

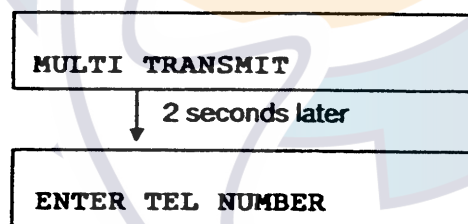

2. Enter subscriber's number. The following methods are available for data entry.
(See note 1 on next page.)

- Direct dialing (maximum five subscribers)
- Abbreviated dialing
- One-touch dialing

3. Press the [AUTO RCV/YES] button.

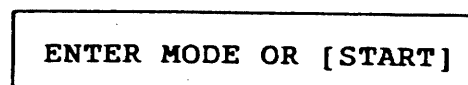

4. Only for the multistation transmission, repeat steps 2 and 3 to enter another subscriber's number.

11c. If desire to return in Japanese language,
from the step 11a;

- i) Press once the button.
Displays [ニホンゴ ?] (Means [JAPANESE ?])
- ii) Continuously press once the button.
The displays returns to the "Idle state".

12. Press once the button.

The display returns to the "Idle state".

13. The language selection is now completed.

This selection procedure applies to the registration of the Terminal ID in the system function setting procedure. The character code should apply to input figures for the Terminal ID.

There are two modes in the various functions. The one is called SYSTEM FUNCTION SET MODE which users enables to set up them, and another is called SET FUNCTION in the Test mode which only service engineer enables to set up them.

7. Press once again the button.

Displays [ニホンゴ ?] This means [JAPANESE ?]

8. Press once the button.

Displays [ENGLISH ?]

9a. If desire to select English language,
press once the button.

Displays [OGM センタク ?] This means [SELECT OGM ?]

9b. If desire to set Japanese language,
press once the button.

Displays [ニホンゴ ?] This means [JAPANESE ?]

9c. If desire to return to Japanese language from the step 8;

i) Press once the button.

Displays [ニホンゴ ?] This means [JAPANESE ?]

ii) Continuously press once the button.

Displays [OGM センタク ?] This means [SELECT OGM ?]

To select a language in OGM system, continue as follows.

10a. Press once the button.

Displays [ニホンゴ ?] This means [JAPANESE ?]

10b. If the LANGUAGE selection is not necessary for OGM,
press once the button.

The display returns to the "Idle state".

11a. If desire to select English language,
press once button.

Displays [ENGLISH ?]

11b. If desire to select Japanese language,
press once button.

The display returns to the "Idle state".

16.8 Equipment initialization.

After completion of the installation, the initialization of the equipment is required to memory clear prior to set various functions.

In case of the initial power switch ON this equipment, some displays in Japanese are expressed on the LCD until English language is selected, however, after English language once has been selected, all expressions are displayed in English excepted power OFF extending over a long period of time or the memory cleared.

To the memory clear, carry out as follows.

1. Power switch ON equipment.

Displays in Japanese as

* [シバラクオマチクダサイ]

** [ジキョクトウロク セッテイ ?]

This means *[WAIT A MOMENT]

**[TEL NUMBER ENTRY ?]

2. Power switch once OFF.

3. Press simultaneously the [1] [3] and [*] buttons, and the power switch ON again with pressed their buttons.

The memory will be cleared, and displays in Japanese as

[ジキョクトウロク セッテイ ?]

This means [TEL NUMBER ENTRY ?]

4. Press the [RESET] button.

Displays as [94-02-24 TEL ユウセン]

This means [DATE TEL], the "Idle state", and the priority is telephone in the receiving mode.

To select English language to display, continue as follows.
(Referred to para. 6.1)

5. Press the [NO] button 6 times.

Displays [ゲンゴ ?] This Means [LANGUAGE ?]

6. Press once the [YES] button.

Displays [ゲンゴセンタク ?]

This means [SELECT LANGUAGE ?]

How to set up fax (PFX-50)

The setting changes to the factory default if the machine is not used for about one month or more. Follow the steps below to set up the fax.

1. Turn on the fax while pressing and holding down [1] [3] and [*] keys together.
2. Press [AUTO RCV/YES].
3. Enter ship's name by referring character code list in the operator's manual.
4. Press [AUTO RCV/YES].
5. Enter the fax number of own station.
6. Press [AUTO RCV/YES] twice.
7. Press [FUNCTION/NO] to change *dial* type from DP to MF.
8. Press [AUTO RCV/YES] twice.
9. Enter Year/month/date and time. For example, type 9902101230 for 12:30, February 1999.
10. Press [AUTO RCV/YES]. After 2 seconds, "TEL/FAX" appears.
11. Press [FUNCTION/NO] three times.
12. Press [YES], [NO], and then [NO].
13. Press [YES], and then [NO] four times.
14. Press [YES].
15. Press [YES].
16. Change receiving mode to FAX by pressing [AUTO RCV/YES] several times.

How to turn off ECM (Changing from EC mode to G3 mode)

Depending on fax data (multi-pages and large image data), necessary is turning off ECM (Error Correction Mode) of the fax PFX-50. The procedure is;

1. Turn on the fax while pressing and holding down [1] and [3].
2. Press [FUNCTION/NO] [8] [FUNCTION/NO] [FUNCTION/NO] [FUNCTION/NO] [AUTO RCV/YES] in this order. Now the screen should look FUNC0=000100010.
3. Press [FUNCTION/NO] several times until FUNC 18=00000110.
4. Press [0] [0] [0] [0] [0] [0] [1] [0] to turn off ECM (change EC mode to G3 mode).
5. Press [AUTO RCV/YES] and then [RESET].
6. Turn off the unit and turn it on again.